

LOC	DIST	REVISIONS			
P	LTR	DESCRIPTION	DATE	OWN	APPD
FT	47	N1	REVISED PER ECO-14-001675	05FEB2014	NK MZ

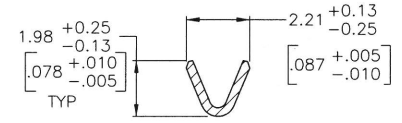

SECTION A-A

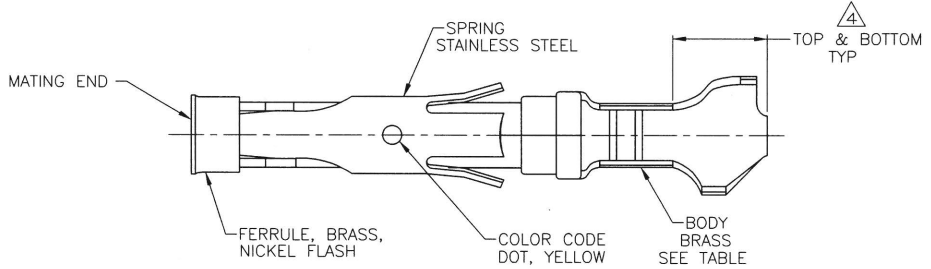
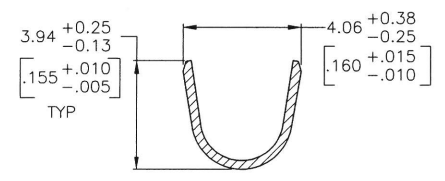
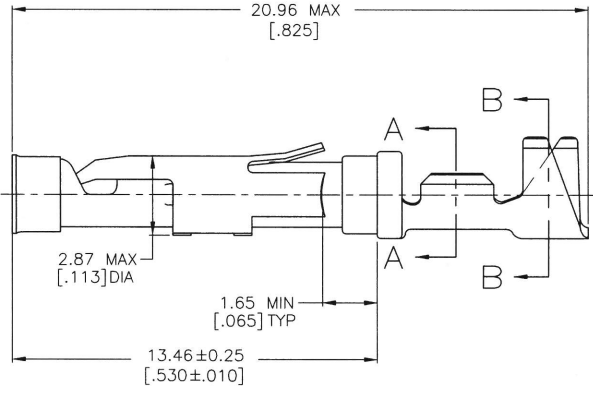
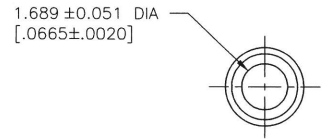

SECTION B-B

- △ 0.76µm [.000030] MIN GOLD PER MIL-G-45204 ON MATING END FOR A LENGTH OF 5.08 [.200] MIN WITH 1.27µm [.000050] MIN MATTE TIN PLATE IN WIRE CRIMP AREA, BOTH OVER 0.76µm [.000030] MIN NICKEL PER QQ-N-290.
- △ 0.76µm [.000030] MIN GOLD PER MIL-G-45204 ON MATING END FOR A LENGTH OF 5.08 [.200] MIN WITH A UNIFORM GRADIENT TO 0.25µm [.000010] MIN GOLD PER MIL-G-45204 ON THE REMAINDER OVER 0.76µm [.000030] MIN NICKEL PER QQ-N-290.
- △ 0.38µm [.000015] MIN GOLD PER MIL-G-45204 ON MATING END FOR A LENGTH OF 5.08 [.200] MIN WITH 1.27µm [.000050] MIN MATTE TIN PLATE IN WIRE CRIMP AREA, BOTH OVER 0.76µm [.000030] MIN NICKEL PER QQ-N-290.
- △ GOLD PLATING NEED NOT APPEAR IN THIS AREA.
- △ 1.27µm [.000050] MIN TIN-LEAD PER MIL-T-10727 OVER 0.76µm [.000030] MIN NICKEL PER QQ-N-290.
- 6 WIRE RANGE 24-20 AWG. INSULATION RANGE 1.52 [.060]-3.05 [.120].
- △ 0.38µm [.000015] MIN GOLD PER MIL-G-45204 ON MATING END FOR A LENGTH OF 5.08 [.200] MIN, 1.27µm [.000050] MIN TIN-LEAD PER MIL-T-10727 FOR A LENGTH OF 5.69 [.224] MIN ON OPPOSITE END, BOTH OVER 1.27µm [.000050] MIN NICKEL PER QQ-N-290 ON ENTIRE CONTACT.

- △ 1.27µm [.000050] MIN TIN PER MIL-T-10727 OVER 0.76µm [.000030] MIN NICKEL PER QQ-N-290.
- △ OBSOLETE PARTS: OBSOLETE CIS STREAMLINING PER D.RENAUD/D.SINISI

STANDARD	△	1-66563-1	66565-7
△ OBSOLETE SMALL PACK	△	66563-4	66565-6
△ OBSOLETE STANDARD	△	1-66563-0	66565-5
STANDARD	△	66563-4	66565-4
STANDARD	△	66563-7	66565-3
STANDARD	△	66563-6	66565-2
STANDARD	△	66563-1	66565-1
PACKAGING TYPE	BODY FINISH	STRIP P/N REF	PART NO

THIS DRAWING IS A CONTROLLED DOCUMENT.

OWN: R. SHIREY 7-31-91	TE Connectivity	
CHK: R. STONE 9-19-91	SOCKET ASSEMBLY, LOOSE PIECE, TYPE III+	
APPD: J. WESTMAN 9-20-91	SIZE: A2	DWG CODE: 00779
PRODUCT SPEC: --	SCALE: 8:1	SHEET: 1 of 1
APPLICATION SPEC: --	REV: N1	RESTRICTED TO: --
MATERIAL: --	WEIGHT: --	CUSTOMER DRAWING
SEE CALLOUTS	SEE CALLOUTS	

66565

A